



global environmental solutions

Lake, Isle of Wight
Heritage Statement
SLR Ref : 406-01490-00016

November 2012



Wm MORRISON SUPERMARKETS PLC

PROPERTY AND DEVELOPMENT DIVISION



FAMIE
Federation of Archaeological Managers & Employers

CONTENTS

1.0 INTRODUCTION.....	3
1.1 Background	3
1.2 Proposed Development	3
1.3 The Site	3
1.4 Sources Consulted.....	4
2.0 HERITAGE ASSETS	5
2.1 Designated Heritage Assets	5
2.2 Non-Designated Heritage Assets.....	5
2.3 Isle of Wight HER Events.....	7
2.4 Isle of Wight Historic Landscape Characterisation.....	8
2.5 Historic Mapping	8
2.6 Assessment of Significance and Sensitivity to Development	9
3.0 RECOMMENDATIONS.....	11
4.0 CONCLUSIONS.....	12
5.0 CLOSURE.....	13

TABLES

Table 1 Listed Buildings within 1km of the Site.....	5
---	----------

FIGURES

Figure 1 Plan of the Proposed Development	3
Figure 2 Aerial Photograph of the Site	10

APPENDICES

Appendix A	IOWHER Monuments
Appendix B	Ordnance Survey Historic Mapping

DRAWINGS

Drawing 1 Designated Heritage Assets

Drawing 2 Non-Designated Heritage Assets

1.0 INTRODUCTION

1.1 Background

SLR Consulting Ltd was commissioned by Wm Morrison Supermarkets Plc in November 2012 to undertake a Heritage Statement for the proposed extension to an existing store at Lake, Isle of Wight; WM Morrison Supermarket, Newport Road, Sandown, Isle of Wight, PO36 9PA (the Site) (Drawing 1). This statement addresses the archaeological and built heritage implications of this proposal. The study area consists of a 1km radius from the boundary of the Site, centred on SZ579833.

This report will be presented with WM Morrison Supermarket's planning application and other technical documents.

1.2 Proposed Development

The proposed development layout is presented in Figure 1. The proposed development is for an extension of 2189m² gross external area, with additional car parking to the south and east. The proposed development includes additional sales floor accommodation with new front of house customer cafe/support facilities and a new staff canteen area. There will also be extensive alterations and internal reconfiguration to the existing layout within the new footprint.



Figure 1 Plan of the Proposed Development

1.3 The Site

The existing WM Morrison Supermarket on the Site is located approximately 2.3km southwest of the centre of Sandown, just off the Newport Road (A3056) on the western bounds of Lake, opposite the industrial units on Lake Industrial Way. The Site is centred at

National Grid Reference 457937.083348. The Site covers an area of approximately 2.92 hectares. The British Geological Survey sheet (1976) composite for the Isle of Wight records that the Site is underlain by Ferruginous Sands Formation of the Lower Greensand Group¹. The Site straddles the 13 metre contour and is generally flat in the central and eastern parts, with the western part of the Site sloping towards the Scotchells Brook².

1.4 Sources Consulted

Sources consulted for this study comprise:

- Isle of Wight County Archaeology and Historic Environment Service Historic Environment Record (IOWHER)
- Heritage Gateway website;
- NMR Spatial Data Download website.
- Ordnance Survey Historic Mapping

¹ Card Geotechnics Limited August 2011 Morrisons, Newport Road, Lake, Isle of Wight-Geoenvironmental Desk Study, 11.

² Card Geotechnics Limited August 2011 Morrisons, Newport Road, Lake, Isle of Wight-Geoenvironmental Desk Study, 8.

2.0 HERITAGE ASSETS

2.1 Designated Heritage Assets

The location of the designated heritage assets within the study area is shown in Drawing 1.

2.1.1 Listed Buildings (*Building Preservation Notices and Certificates of Immunity*)

Five Listed buildings are located within 1km of the Site. All the listed buildings within the study area are Grade II listed. Merrie Gardens Farmhouse, a late 17th-early 18th century building, altered in the 19th century, is the nearest Listed building, 0.08km to the east of the Site. The remaining listed buildings are all over 0.6km from the Site. There are no Building Preservation Notices or Certificates of Immunity within 1km of the Site.

Table 1 Listed Buildings within 1km of the Site

List Entry Number	Name	Grade
1034308	CHURCH OF THE GOOD SHEPHERD	II
1034324	CHEVERTON FARM BARN	II
1213128	LANDGUARD MANOR	II
1290575	CHEVERTON FARMHOUSE	II
1365381	MERRIE GARDENS FARMHOUSE	II

2.1.2 Scheduled Monuments

There are no scheduled monuments within 1km of the Site. The nearest is Sandown Barrack Battery, 1.35km to the northeast.

2.1.3 Conservation Areas, Registered Parks and Gardens, Registered Battlefields, Protected Wreck Sites and World Heritage Sites

There are no Conservation Areas, Registered Parks and Gardens, Registered Battlefields, Protected Wreck Sites and World Heritage Sites within 1km of the Site.

2.2 Non-Designated Heritage Assets

The location of non-designated heritage assets (IOWHER monuments Appendix A) within the study area is shown in Drawing 2.

2.2.1 Isle of Wight HER Monuments Prehistoric (500,000 BC-43AD)

Considerable prehistoric activity is evident within the study area.

Prehistoric (general)

The prehistoric IOWHER monument records comprise findspots (MIW842, MIW1294, MIW1308, MIW1318, MIW1360), flint scatters (MMIW1360, MIW4790 and MIW13446) and

lithic working, a findspot and pits at Lake Middle School (MIW2313). The nearest findspot or flint scatter is Sandown Bay 0.45km to the south of the Site.

Palaeolithic

Palaeolithic Axe(s) were found 1914 in a small pocket of gravel at Ninham 0.89km to the southwest of the Site (MIW838). An implement of Le Moustier type found at Black Pan Farm 0.70km to the northeast of the Site (MIW847).

Mesolithic

Blackpan Common (MIW860) 0.52 km to the southeast has produced implements of various cultures dating from the Early Mesolithic to Bronze Age. Mesolithic types include picks, microliths, flakes, cores and petit tranchet derivatives of Clark's types G and G2.

Blackpan Farm 0.65km west of the Site has generated a range of worked lithics dating from the Early Mesolithic to the Early Neolithic (MIW845).

Neolithic

Two Neolithic axes, scrapers and flakes have been discovered at Languard Farm 0.08km to the east of the Site (MIW835). A Neolithic polished stone axe of basalt found at Merry Gardens 0.85km east of the Site (MIW841). A Neolithic occupation/flint working site comprising a hearth with flakes, wasters and implements around it was found when a bank was levelled at Lea Farm (MIW848) 0.98km to the south of Site.

Blackpan Common (MIW860) 0.52 km to the southeast has produced implements of various cultures dating from the Early Mesolithic to Bronze Age. Neolithic Age implements were found at Blackpan Farm (MIW846) 0.66km west of Site.

Flint implements including scrapers and arrowheads dating from the Neolithic and Bronze Age were discovered at Lake (MIW854) 0.84km east of the Site.

Bronze Age.

Three Bronze Age findspots have been found within 1km of the Site (MIV839, MIW843 and MIV851), the nearest of which is a barbed and tanged arrowhead found 0.27km to the northeast. One possible Bronze Age pit was recorded during a watching brief at Ninham Farm (MIW1623) 0.91km to the southeast of the Site.

Blackpan Common (MIW860) 0.52 km to the southeast has produced implements of various cultures dating from the Early Mesolithic to Bronze Age. Bronze Age implements were found at Blackpan Farm (MIW846) 0.66km west of Site. Flint implements including scrapers and arrowheads dating from the Neolithic and Bronze Age were discovered at Lake (MIW854) 0.84km east of the Site.

Linear features of uncertain date are visible as cropmarks likely to be field boundaries are visible on aerial photographs and are dated from the Early Bronze Age to the 20th century 0.28km west of the Site (MIW2238).

Iron Age

A potsherd was found during the construction of Lake Middle School 0.60km to the southeast in 1970 (MIW1664). A bead rim urn cremation was unearthed in October 1931 by workmen making a new road between Newport Road and Lake Cemetery 0.86km northwest

of the Site (MIW850). Five Iron Age pits were recorded during a watching brief at Ninham farm (MIW1623) 0.91km to the southeast of the Site.

2.2.2 Isle of Wight HER Monuments Romano-British (43AD-410AD)

All of the Isle of Wight HER monuments dated to the Roman period are findspots (MIW836, MIW852, MIW959 and MIW1354). The nearest is a Roman coin of Constantius II found in 1939 at Shanklin (MIW836) 0.06km to the east of the Site. Roman pottery was also found at Sandown Cliff (MIS1676) 0.83km east of the Site.

2.2.3 Isle of Wight HER Monuments Medieval (410AD-1540AD)

Blackpan is recorded in Domesday as *Bochepone* and is located 0.48km to the northeast of Site (MIW6653). Lea farm is entitled with the Domesday placename *Alalei* 0.25km northeast of Site (MIW6678). Scotchells is noted to possess the Domesday placename *Scaldeford* 0.91km to the southwest of the Site.

2.2.4 Isle of Wight HER Monuments Post-medieval-Modern Period (1540AD-20th century)

The 19th century barn at Bigbury Farm, Alveston Road is located adjacent to the Site (MIW13748). The post-medieval boundary stone Little Stairs Point is located 0.03km south and a mid 17th to mid 18th century barn on Cheverton Farm (MIW9532) is located 0.13km to the west of the Site. The late 19th century Church of the Good Shepherd is located 0.14km east of the Site (MIW12168).

Post-medieval postholes, pits and ditches were recorded during a watching brief at Ninham Farm (MIW1623) 0.91km to the southeast of the Site. Post medieval pottery was found at Sandown Cliff (MIS1676) 0.83km east of the Site. Linear features of uncertain date which are likely to be field boundaries, are visible on aerial photographs and are dated from the Early Bronze Age to the 20th century (MIW2238).

The remaining 39 (save the undated IOWHER monument below) Isle of Wight HER monuments are classed as post-medieval to modern in date.

2.2.5 Isle of Wight HER Monuments Undated

The Farmhouse at Bigbury Farm (MIW13749) located 0.94km to the east of the Site is undated.

2.3 Isle of Wight HER Events

Seven Isle of Wight HER events are located within 1km of the Site.

The SeaClean pipeline (EIW193) runs through the Site aligned northeast-southwest. In 2000, a programme of archaeological works associated with the construction of the SeaClean Wight Pipelines was undertaken. The archaeological monitoring along the route from Yarmouth to Sandown identified 55 sites ranging from find scatters to features and deposits, ranging in date from the prehistoric to post-medieval periods.'

The Isle of Wight Aggregate Areas National Mapping Programme (EIW464) covers the western majority of the Site.

At Merrie Gardens (EIW747) 0.08km to the southeast, an archaeological watching brief was carried out during the groundworks associated with the construction of a new pub and car

park. Late post-medieval or modern activity relating to the former farm was discovered. A channel or depression, cobbled surfaces and a well or cistern were recorded.

At Lake Middle School (EIW185 and EIW3), 0.28km and 0.33km to the east, a watching brief (EIW185) was undertaken in advance of the construction of a classroom extension. The watching brief identified evidence for prehistoric and later activity comprising a gully, possibly delineating a settlement boundary and rubbish pits. Domestic Late Neolithic and Early Bronze Age occupation was apparent, with evidence for flint knapping. Early Romano-British features and artefacts predominated, with less post-Roman and later material, possibly reflecting a change in settlement focus. Notable finds include a flint arrowhead, worked flint tools and late Iron Age and Romano-British ceramics. Archaeological evaluation (EIW3) prior to the construction of a classroom extension at Lake Middle School, provided evidence of prehistoric settlement during the Neolithic/Early Bronze Age and Iron Age.

A survey at Sandown Cemetery (EIW517), 0.55km to the northeast of the Site, was completed by the Isle of Wight Gardens Trust in 1999.

At Lake Allotments (EIW11) 0.71km to the northeast, a trial trench was excavated following the discovery of complete Roman poppy head beaker. One flint blade was found but the pot may have been redeposited when soil was moved from a nearby sand pit.

2.4 Isle of Wight Historic Landscape Characterisation

The majority of the Site is recorded as Safeway Supermarket, Lake and recorded with the Broad HLC Type of Settlement (2726). The Safeway supermarket was built around 1990 within a former field to the west of Merrie Gardens Farm. This field had the appearance of being enclosed from former waste or common land.

The very northern tip of the Site is recorded as Scotchells Brook Valley (South) and recorded with the Broad HLC Type of Valley Floor (3341). The Tithe schedule lists a mixture of pasture, meadow, valley floor woodland and some rough land within this area.

2.5 Historic Mapping³

The historic mapping is provided in Appendix B. The Ordnance Survey County Series mapping of 1862 (scale 1:2,500) and 1861-1863 (scale 1:10,560) shows the Site located to the northeast of Scotchells Bridge as two enclosures, with the boundary between the two aligned northeast-southwest. The western enclosure is depicted with marshy area extending along the eastern side. 'Merry Gardens' are situated to the southeast and a Sand Pit is marked to the south of the Site. A stream (Scotchells Brook, marked on current Ordnance Survey mapping) represents the western boundary, which flows northwards, with a small tributary which issues from 'Merry Gardens' and feeds the Scotchells Brook to the north of the Site.

The Ordnance Survey County Series mapping of 1896 (scale 1:10,560) and 1898 (scale 1:2,500) marks the Enumeration District Boundary ('E.D. By') (later shown as the 'ED and Ward By' on the Ordnance Survey 1987; scale 1:2,500 mapping) as the western boundary of the Site. A Lodge is marked to the south of the Site.

³ Card Geotechnics Limited August 2011 Morrisons, Newport Road, Lake, Isle of Wight- Geoenvironmental Desk Study Appendix C; Historic Mapping

The Ordnance Survey County Series mapping of 1908 (scale 1:2,500) shows a small rectangular building aligned north-south immediately southeast of the Site but this is no longer depicted in subsequent historic mapping. The Ordnance Survey County Series mapping of 1907-1909 (scale 1:10,560) shows no changes within the bounds of the Site but the western boundary is now represented by the Urban District boundary; 'U.D. By'. Sandown and Shanklin Isolation Hospital is depicted to the west of the Site. 'Scotchells Withybed' is now marked to the southwest. The Ordnance Survey County Series mapping of 1938-1942 (scale 1:10,560) shows no change within the bounds of the Site.

The Provisional mapping of 1957 (scale 1:10,560) shows no alteration to the Site. The Ordnance Survey mapping of 1960 and 1969 (scale 1:2,500) only depicts the far eastern part of the Site and the Air Conditioning and Refrigeration Works are shown to the south. The Ordnance Survey mapping of 1975 (scale 1:2,500) shows the western part of the Site, with no changes depicted, but a track now runs along the northern boundary. Airport Lodge, Sandlin and a Builder's Yard are now shown on the site of the former Sandown and Shanklin Isolation Hospital. A nursery is shown to the west of the Site. The Ordnance Survey mapping of 1980 (scale 1:10,560) shows no changes to the Site.

The Ordnance Survey mapping of 1987 (scale 1:2,500) shows the western part of the Site, with no changes within its bounds but an electricity Sub Station and Lake Industrial Way is now indicated to the south of the Site. The Ordnance Survey mapping of 1988 (scale 1:2,500) only depicts the eastern part of the Site and does show an excavated area flanking the Site to the north. The Raster map of 2002 (scale 1:10,000) shows the Site much as it is currently save the western boundary represented by the civil parish boundary and it appears that the building to the west of the supermarket has subsequently had its footprint revised. The Ordnance Survey 2011 (scale 1:10,000) and MasterMap 2011 (scale 1:2,500) depict the existing supermarket, building and parking.

2.6 Assessment of Significance and Sensitivity to Development

2.6.1 Predicted Direct impact

The proposed development is the extension to an existing store and therefore much of the Site has already been subject to ground disturbance as shown in the current aerial photograph (Figure 2). There are no designated or non-designated heritage assets within the bounds of the Site. Scotchells Bridge, immediately to the southwest will not be impacted upon. The small rectangular building shown on the Ordnance Survey County Series mapping of 1908 (scale 1:2,500) immediately southeast of the Site is not depicted in subsequent historic mapping, in an area that has been subject to ground disturbance and currently used for parking (Figure 2).



Figure 2 Aerial Photograph of the Site⁴

2.6.2 Predicted Indirect impact

The setting of the Grade II listed Merrie Gardens Farmhouse and the Merrie Gardens Farm complex may be slightly impacted upon by the proposed development e.g. possible increased levels of intervisibility. However, given the precedent set by the existing supermarket and surrounding developments, particularly to the southwest around Lake Industrial Way, the impact of the development is considered to be negligible.

⁴ David Weatherill Partnership November 2012 Design and Access Statement Proposed Extension WM Morrison Supermarket Lake, Isle of Wight, 4.

3.0 RECOMMENDATIONS

Given the levels of disturbance associated with the construction of the existing store and parking as indicated on the current aerial photograph of the Site, the proposed development is highly unlikely to result in any level of direct impact.

Pre-application consultation should be undertaken with the Isle of Wight Conservation and Design Team to ensure agreement about the negligible degree of impact of the proposed development upon the setting of the Grade II listed Merrie Gardens Farmhouse.

4.0 CONCLUSIONS

- The proposed development is an extension to an existing store.
- There are no designated or non-designated heritage assets within the bounds of the Site.
- Given the high levels of ground disturbance on the Site, no direct impacts are anticipated on any potential surviving unknown archaeological remains.
- Due to the existing development around the Listed Merrie Gardens Farmhouse, it is considered that the proposed extension will result in a negligible impact on the setting of this designated heritage asset.

5.0 CLOSURE

This report has been prepared by SLR Consulting Limited with all reasonable skill, care and diligence, and taking account of the manpower and resources devoted to it by agreement with the client. Information reported herein is based on the interpretation of data collected and has been accepted in good faith as being accurate and valid.

This report is for the exclusive use of Wm Morrison Supermarkets Plc; no warranties or guarantees are expressed or should be inferred by any third parties. This report may not be relied upon by other parties without written consent from SLR.

SLR disclaims any responsibility to the client and others in respect of any matters outside the agreed scope of the work.

DRAWINGS

REPRODUCED BY PERMISSION OF ORDNANCE SURVEY ON BEHALF OF HMSO. CROWN COPYRIGHT AND DATABASE RIGHT
 OS DATA LICENCE EXPIRATION: 22/11/2013
 ALL RIGHTS RESERVED. LICENCE NUMBER A110012293

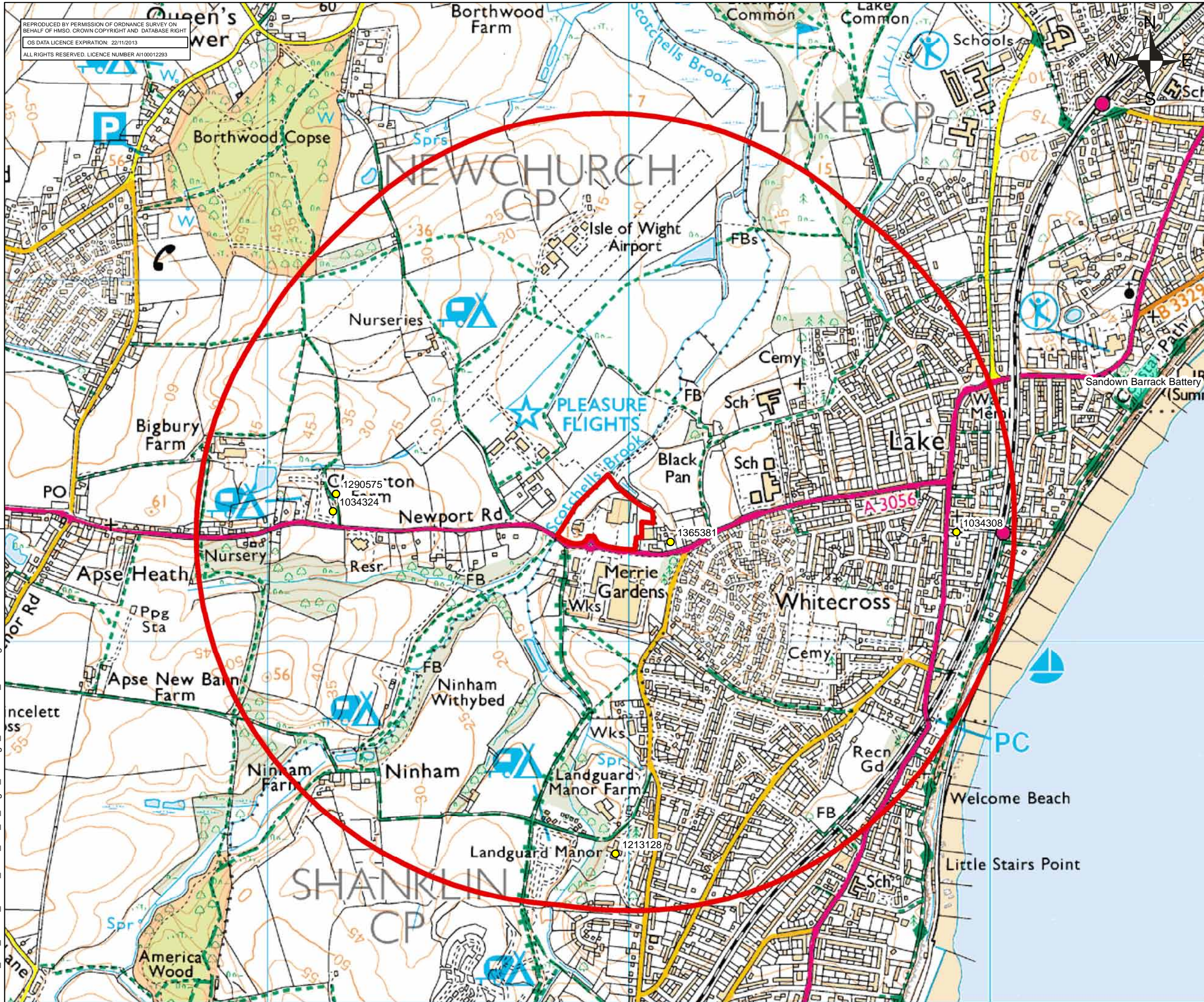

NOTES
 1. NOTES

- LEGEND
- Listed Buildings
 - Scheduled Monuments
 - Site Boundary and 1km Buffer

121127_406_01490_00016_Lake_Isle_of_Wight_Heritage_Statement_Drawing 1

 Wm MORRISON SUPERMARKETS PLC
 PROPERTY AND DEVELOPMENT DIVISION



 69 POLSLOE ROAD
 EXETER
 DEVON
 EX1 2NF
 T: 01392 490152
 F: 01392 495572
 www.slrconsulting.com

LAKE, ISLE OF WIGHT
 HERITAGE STATEMENT
DESIGNATED HERITAGE ASSETS

1

Scale 1:10,000 @ A3 Date NOVEMBER 2012

REPRODUCED BY PERMISSION OF ORDNANCE SURVEY ON BEHALF OF HMSO. CROWN COPYRIGHT AND DATABASE RIGHT
 OS DATA LICENCE EXPIRATION: 22/11/2013
 ALL RIGHTS RESERVED. LICENCE NUMBER A100012293

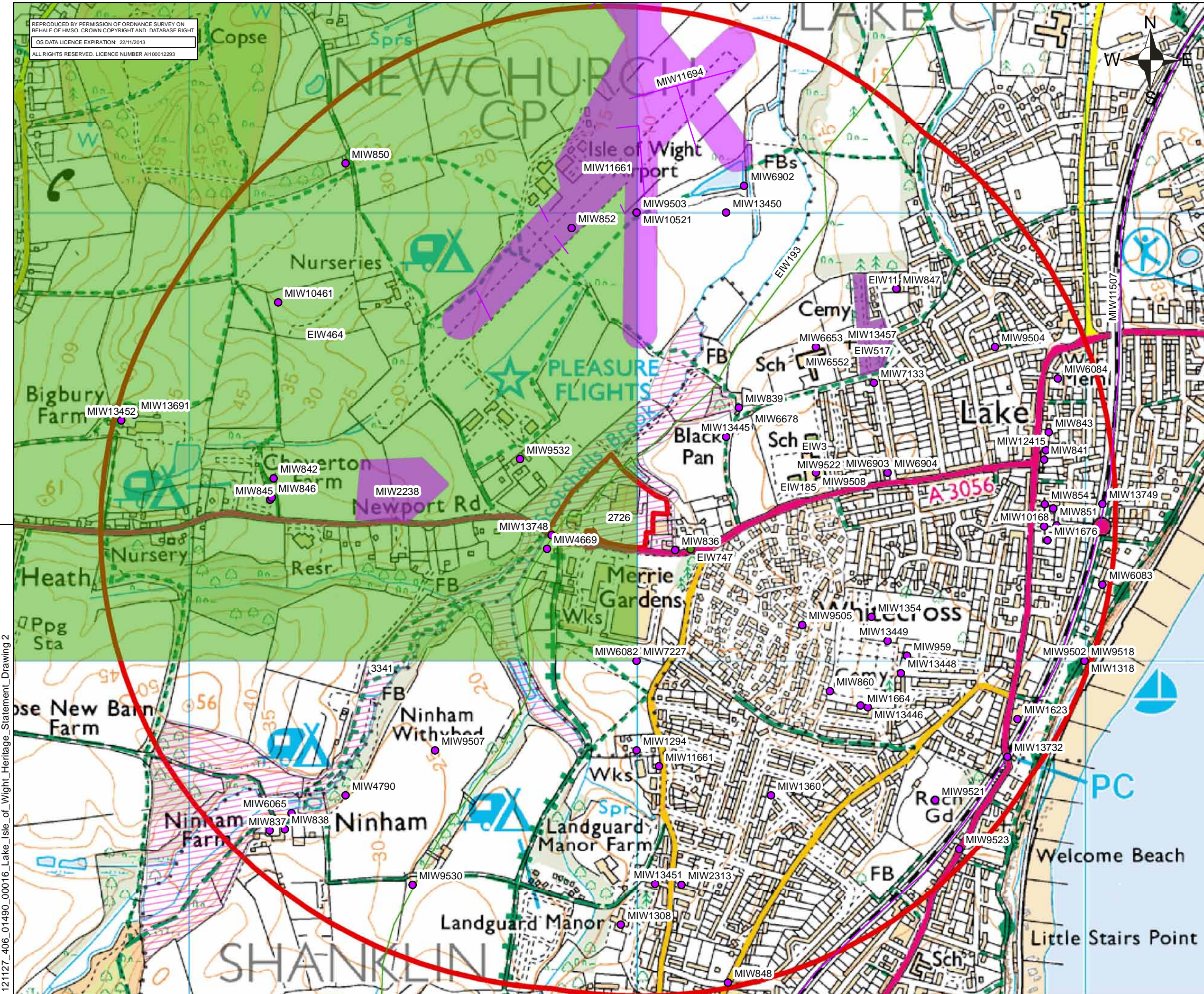

NOTES	
1. NOTES	
LEGEND	
	IOWHER Monument Point
	IOWHER Monument Line
	IOWHER Monument Polygon
	IOWHER Event Point
	IOWHER Event Line
	IOWHER Event Polygon
	IOWHER HLC Polygon
	Site Boundary and 1km Buffer

Wm MORRISON SUPERMARKETS PLC
 PROPERTY AND DEVELOPMENT DIVISION

SLR
 69 POLSLOE ROAD
 EXETER
 DEVON
 EX1 2NF
 T: 01392 490152
 F: 01392 495572
 www.slrconsulting.com

LAKE, ISLE OF WIGHT
 HERITAGE STATEMENT
NON-DESIGNATED HERITAGE ASSETS

2

Scale 1:8,000 @ A3 Date NOVEMBER 2012

121127_406_01490_00016_Lake_Isle_of_Wight_Heritage_Statement_Drawing 2

APPENDIX A

Appendix A IOWHER Monuments

MONUID	NAME	MONTYPE	DATE
MIW9523	20-28 Sandown Road, Lake	SHOP	Early C19 to Mid C19 - 1801 AD to 1840 AD
MIW13748	Barn at Bigbury Farm, Alverstone Road, Apse Heath	BARN	C19 - 1801 AD to 1900 AD
MIW847	Black Pan Farm.	FINDSPOT	Lower Palaeolithic - 500000 BC? to 150001 BC?
MIW860	Blackpan Common	LITHIC WORKING SITE, FLINT SCATTER, FINDSPOT, FINDSPOT	Early Mesolithic to Bronze Age - 10000 BC to 701 BC
MIW9518	Blackpan Farm, Merrie Gardens, near Lake	FARM BUILDING	Mid C18 to Mid C19 - 1750 AD to 1850 AD
MIW846	Blackpan Farm.	FLINT SCATTER, FLINT SCATTER	Neolithic to Bronze Age - 4000 BC to 701 BC
MIW845	Blackpan Farm.	FLINT SCATTER, FINDSPOT	Early Mesolithic to Early Neolithic - 10000 BC to 4000 BC
MIW6653	Blackpan.	SETTLEMENT	Medieval - 1066 AD to 1539 AD
MIW6065	Borthwood	NONCONFORMIST CHAPEL	Late C19 - 1867 AD to 1900 AD
MIW6552	Borthwood Copse.	AIRCRAFT CRASH SITE	Modern - 1901 AD to 2050 AD
MIW2238	Cheverton Farm, Apse Heath	FIELD BOUNDARY	Early Bronze Age to C20 - 2200 BC to 1945 AD
MIW9532	Cheverton Farm, Newport Road, Apse Heath	BARN	Mid C17 to Mid C18 - 1650 AD to 1750 AD
MIW12168	Church of the Good Shepherd, Lake	CHURCH HALL	Late C19 to Modern - 1867 AD to 2050 AD
MIW6083	Church of the Good Shepherd, Lake.	CHURCH	Post Medieval - 1540 AD to 1900 AD
MIW13691	County Ground, Green Lane, Shanklin	CRICKET GROUND	Late C19 - 1867 AD to 1900 AD
MIW9521	Dale Cottage, Sandown Road, Lake	HOUSE	Early C19 to Mid C19 - 1801 AD to

			1860 AD
MIW10521	Edward VIII post box, Green Lane, Shanklin	POST BOX	C20 - 1936 AD
MIW1318	Fairway, Sandown.	FINDSPOT	Prehistoric - 500000 BC to 42 AD
MIW13749	Farmhouse, Bigbury Farm, Alverstone Road, Apse Heath	FARMHOUSE	Undated
MIW9530	Farmhouse, Cheverton Farm, Newport Road, Apse Heath	FARMHOUSE	Mid C17 to Mid C18 - 1650 AD to 1750 AD
MIW6084	Heath Road, Lake	NONCONFORMIST CHAPEL	Post Medieval - 1540 AD to 1900 AD
MIW6903	Heath Road, Lake.	BRIDGE	Post Medieval - 1540 AD to 1900 AD
MIW854	Lake	FINDSPOT, FINDSPOT	Neolithic to Bronze Age - 4000 BC to 701 BC
MIW959	Lake Allotment	FINDSPOT	Roman - 43 AD to 409 AD
MIW9522	Lake Antiques & Anglia Building Society, 18 Sandown Road, Lake	SHOP	Early C19 to Mid C19 - 1801 AD to 1850 AD
MIW843	Lake Farm.	FINDSPOT	Bronze Age - 2350 BC to 701 BC
MIW1664	Lake Hill	FINDSPOT	Iron Age - 800 BC to 42 AD
MIW12415	Lake Methodist Church	CHURCH	Modern - 1901 AD to 2050 AD
MIW2313	Lake Middle School	LITHIC WORKING SITE, PIT, PIT, PIT, FINDSPOT	Prehistoric - 500000 BC to 42 AD and Iron Age to Saxon - 800 BC to 1065 AD
MIW852	Lake.	FINDSPOT	Roman - 43 AD to 409 AD
MIW850	Lake.	CREMATION	Iron Age - 800 BC to 42 AD
MIW842	Lake.	FINDSPOT	Prehistoric - 500000 BC to 42 AD
MIW10461	Landguard Manor, Landguard Manor Road, Shanklin	HOUSE	Early C18 to Late C19 - 1701 AD to 1900 AD
MIW835	Languard Farm, Shanklin.	FINDSPOT	Neolithic - 4000 BC to 2351 BC
MIW848	Lea Farm.	HEARTH, LITHIC WORKING SITE	Neolithic - 4000 BC to 2351 BC
MIW6678	Lea Farm.	SETTLEMENT	Medieval - 1066 AD to 1539 AD
MIW9502	Little Landguard & Dunchurch, Whitecross Lane, near Lake	HOUSE	Early C19 to Mid C19 - 1801 AD to 1860 AD

MIW4669	Little Stairs Point.	BOUNDARY STONE	Post Medieval - 1540 AD to 1900 AD
MIW851	Manor Road, Lake.	FINDSPOT	Bronze Age - 2350 BC to 701 BC
MIW9505	Merrie Gardens Farm, Newport Road, near Lake	BARN	Mid C18 to Mid C19 - 1750 AD to 1850 AD
MIW9504	Merrie Gardens Farm, Newport Road, near Lake	FARMHOUSE	Mid C17 to Mid C18 - 1650 AD to 1750 AD
MIW841	Merry Gardens.	FINDSPOT	Neolithic - 4000 BC to 2351 BC
MIW1623	N.E. of Ninham Farm (AP evidence and SeaClean)	RING DITCH, PIT, PIT, DITCH, PIT	Bronze Age to Iron Age - 2350 BC to 42 AD and Post Medieval - 1540 AD to
MIW1354	New Road, Lake.	FINDSPOT	Roman - 43 AD to 409 AD
MIW9508	Ninham Farm, Ninham, near Shanklin	FARMHOUSE	C18 - 1701 AD to 1800 AD
MIW9507	Ninham Farm, Ninham, near Shanklin	BARN	C18 - 1701 AD to 1800 AD
MIW839	Ninham.	FINDSPOT	Bronze Age - 2350 BC to 701 BC
MIW838	Ninham.	FINDSPOT	Lower Palaeolithic - 500000 BC to 150001 BC
MIW11507	Ryde - Ventnor Railway	RAILWAY	Mid C19 to Modern - 1860 AD to 2050 AD
MIW1360	Sandham Gardens, Lake	FINDSPOT, FLINT SCATTER	Prehistoric - 500000 BC to 42 AD
MIW11694	Sandown Airport	AIRCRAFT OBSTRUCTION	C20 - 1939 AD to 1945 AD
MIW11661	Sandown Airport	AIRPORT	C20 to Modern - 1935 AD to 2009 AD
MIW11661	Sandown Airport	AIRPORT	C20 to Modern - 1935 AD to 2009 AD
MIW1294	Sandown Bay	FINDSPOT	Prehistoric - 500000 BC to 42 AD
MIW13457	Sandown Cemetery	CEMETERY	C20 - 1901 AD to 2000 AD
MIW1676	Sandown Cliff	FINDSPOT, FINDSPOT	Roman - 43 AD to 409 AD and Post Medieval - 1540 AD to 1900 AD
MIW6902	Scotchells Bridge.	BRIDGE	Post Medieval - 1540 AD to 1900 AD

MIW6082	Scotchell's Bridge.	INFECTIOUS DISEASES HOSPITAL	Post Medieval - 1540 AD to 1900 AD
MIW837	Scotchells.	DESERTED SETTLEMENT	Medieval - 1066 AD to 1539 AD
MIW4790	SeaClean - West of Lower Hyde, Shanklin	FLINT SCATTER	Prehistoric - 500000 BC to 42 AD
MIW7227	Shanklin Cemetery	CEMETERY	Post Medieval - 1540 AD to 1900 AD
MIW13452	Shanklin Cemetery	BOUNDARY BANK	Post Medieval - 1540 AD to 1900 AD
MIW13451	Shanklin Cemetery	LYCH GATE	Late C19 - 1867 AD to 1900 AD
MIW13449	Shanklin Cemetery	BOUNDARY BANK	Post Medieval - 1540 AD to 1900 AD
MIW13448	Shanklin Cemetery	BOUNDARY BANK	Post Medieval - 1540 AD to 1900 AD
MIW13446	Shanklin Cemetery	FLINT SCATTER	Prehistoric - 500000 BC to 42 AD
MIW10168	Shanklin Gas Co. Office, Landguard Road, Shanklin	INDUSTRIAL BUILDING	Mid C19 to Late C19 - 1850 AD to 1900 AD
MIW836	Shanklin.	FINDSPOT	Roman - 43 AD to 409 AD
MIW7133	Skew Bridge Works, Lake	POWER STATION	Modern - 1901 AD to 2050 AD
MIW6904	Skew Bridge.	BRIDGE	Post Medieval - 1540 AD to 1900 AD
MIW9531	Stable, Cheverton Farm, Newport Road, Apse Heath	STABLE	Early C19 to Mid C19 - 1801 AD to 1850 AD
MIW1308	Street End	FINDSPOT	Prehistoric - 500000 BC to 42 AD
MIW13732	The Coach House, Languard Manor Road, Shanklin	COACH HOUSE?	Late C19 - 1867 AD to 1900 AD
MIW9503	The Cottage, Newport Road, near Lake	HOUSE	Mid C18 to Late C18 - 1750 AD to 1800 AD
MIW13450	The Lodge, Shanklin Cemetery (now Rose Lodge)	CEMETERY LODGE	Late C19 - 1867 AD to 1900 AD
MIW13445	Vicarage to the Church of the Good Shepherd, Lake	VICARAGE	C20 - 1930 AD

Site Details:

WM MORRISON
 SUPERMARKETS
 PLC, SERVICE
 STATION, NEWPORT
 ROAD, LAKE, SANDOWN, PO36
 9PA

Client Ref: 4960
Report Ref: CMAPS-AAA-86130-4960-020811HIS
Grid Ref: 457922, 83350

Map Name: MasterMap

Map date: 2011

Scale: 1:2,500

Printed at: 1:2,500



Produced by
 GroundSure Environmental Insight
www.groundsure.com



Supplied by:
www.centremapslive.com
Groundsure@centremaps.com

Crown copyright all rights reserved. Licence No: 100035207

Production date: 02 August 2011

To view map legend click here [Legend](#)





Site Details:

WM MORRISON
SUPERMARKETS
PLC, SERVICE
STATION, NEWPORT
ROAD, LAKE, SANDOWN, PO36
9PA

Client Ref: 4960
Report Ref: CMAPS-AAA-86130-4960-020811HIS
Grid Ref: 457922, 83350

Map Name: National Grid

Map date: 1988

Scale: 1:1,250

Printed at: 1:2,500

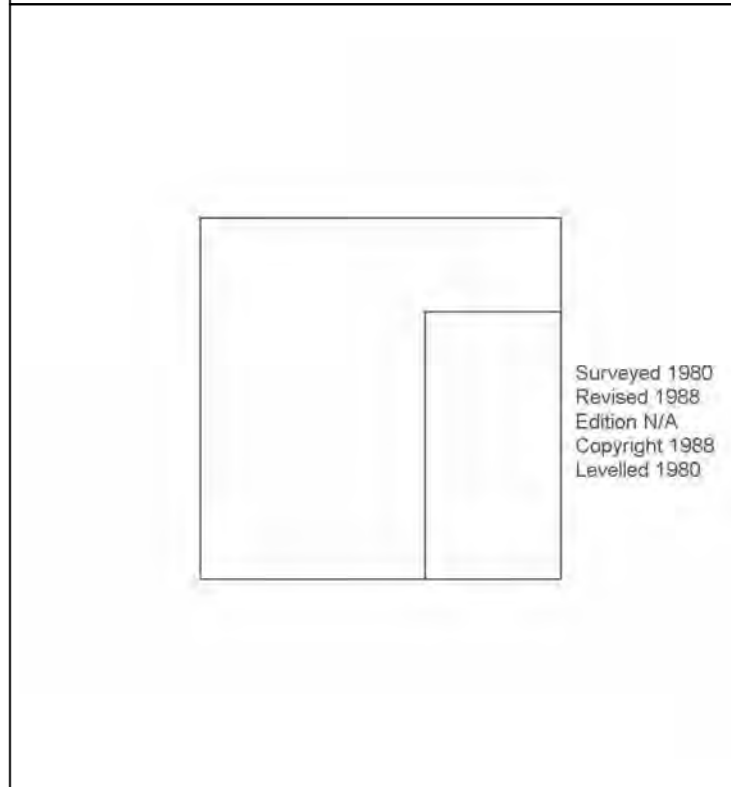

Surveyed 1980
Revised 1988
Edition N/A
Copyright 1988
Levelled 1980



Produced by
GroundSure Environmental Insight
www.groundsure.com



Supplied by:
www.centremapslive.com
Groundsure@centremaps.com

Crown copyright all rights reserved. Licence No: 100035207

Production date: 02 August 2011

To view map legend click here [Legend](#)



Site Details:

WM MORRISON
SUPERMARKETS
PLC, SERVICE
STATION, NEWPORT
ROAD, LAKE, SANDOWN, PO36
9PA

Client Ref: 4960
Report Ref: CMAPS-AAA-86130-4960-020811HIS
Grid Ref: 457922, 83350

Map Name: National Grid

Map date: 1975

Scale: 1:2,500

Printed at: 1:2,500



Surveyed 1975
Revised 1975
Edition N/A
Copyright 1976
Levelled 1959

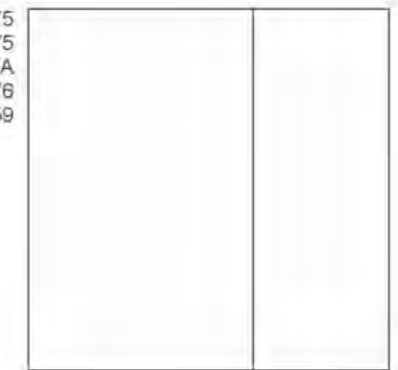

Produced by
GroundSure Environmental Insight
www.groundsure.com



Supplied by:
www.centremapslive.com
Groundsure@centremaps.com

Crown copyright all rights reserved. Licence No: 100035207

Production date: 02 August 2011

To view map legend click here [Legend](#)

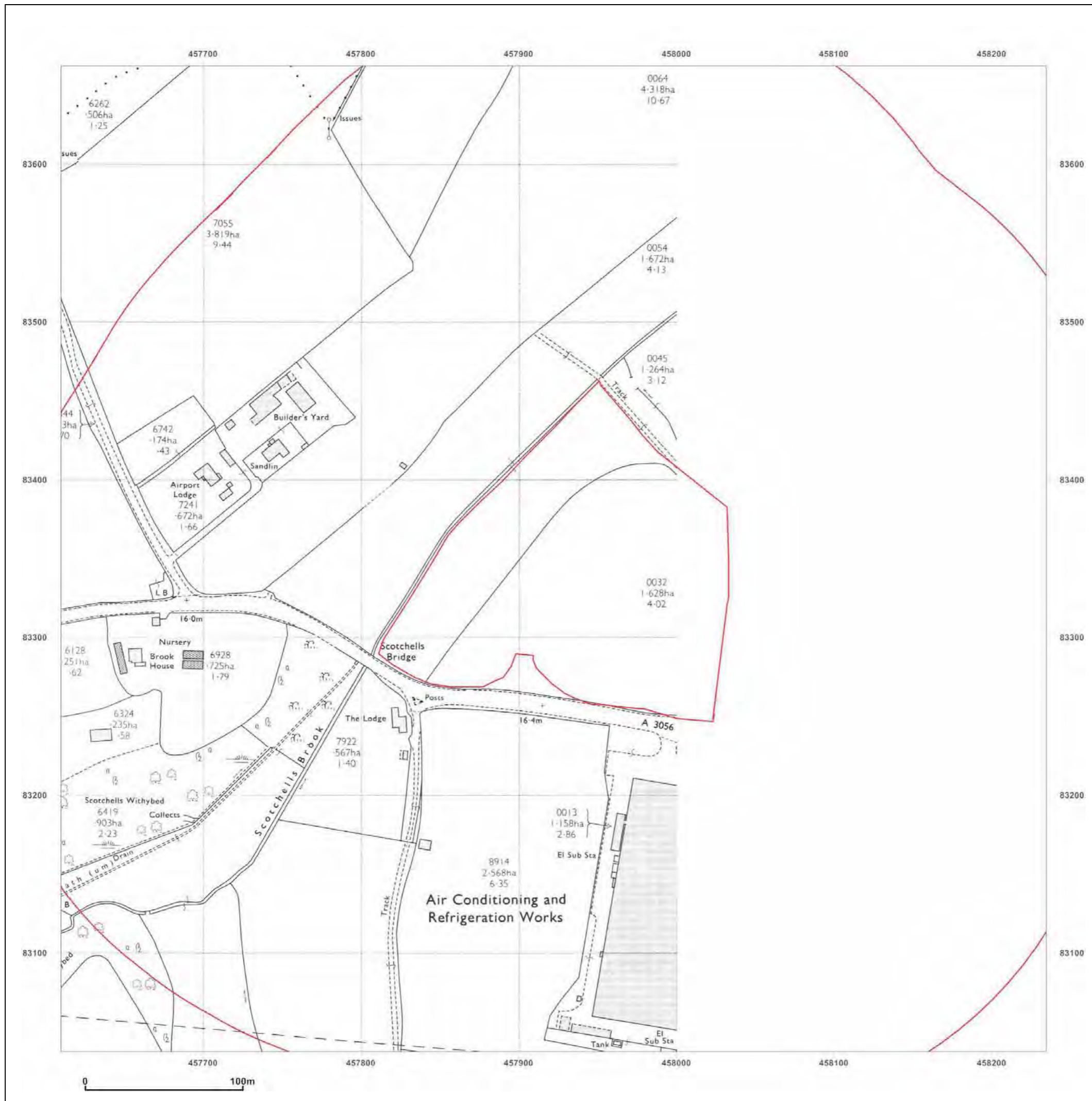



Site Details:

WM MORRISON
SUPERMARKETS
PLC, SERVICE
STATION, NEWPORT
ROAD, LAKE, SANDOWN, PO36
9PA

Client Ref: 4960
Report Ref: CMAPS-AAA-86130-4960-020811HIS
Grid Ref: 457922, 83350

Map Name: National Grid

Map date: 1969

Scale: 1:2,500

Printed at: 1:2,500



Surveyed 1969
Revised 1969
Edition N/A
Copyright 1970
Levelled 1960



Produced by
GroundSure Environmental Insight
www.groundsure.com



Supplied by:
www.centremapslive.com
Groundsure@centremaps.com

Crown copyright all rights reserved. Licence No: 100035207

Production date: 02 August 2011

To view map legend click here [Legend](#)

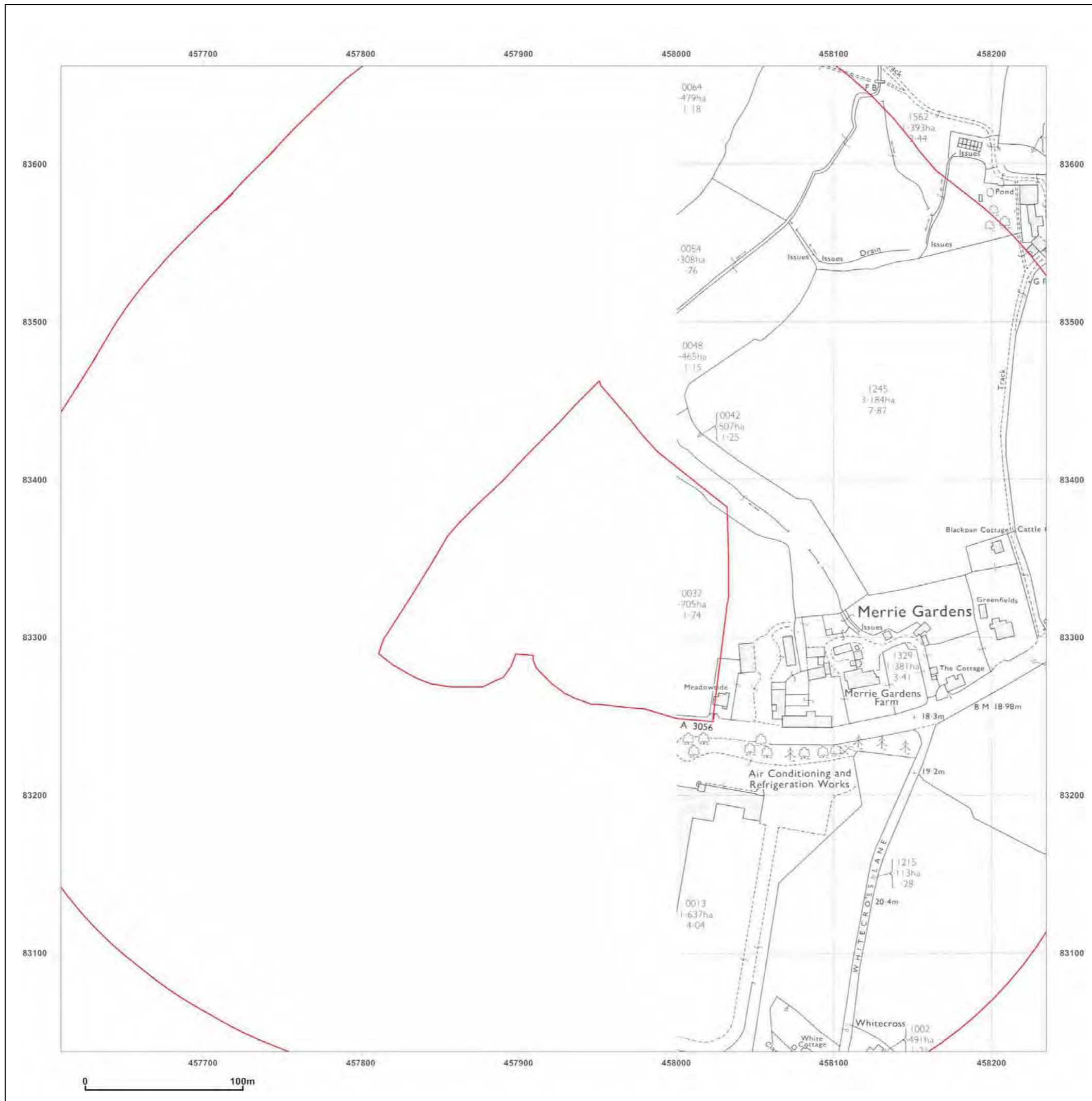



Site Details:

WM MORRISON
SUPERMARKETS
PLC, SERVICE
STATION, NEWPORT
ROAD, LAKE, SANDOWN, PO36
9PA

Client Ref: 4960
Report Ref: CMAPS-AAA-86130-4960-020811HIS
Grid Ref: 457922, 83350

Map Name: National Grid

Map date: 1960

Scale: 1:2,500

Printed at: 1:2,500



Surveyed N/A
Revised N/A
Edition N/A
Copyright N/A
Levelled 1960



Produced by
GroundSure Environmental Insight
www.groundsure.com



Supplied by:
www.centremapslive.com
Groundsure@centremaps.com

Crown copyright all rights reserved. Licence No: 100035207

Production date: 02 August 2011

To view map legend click here [Legend](#)

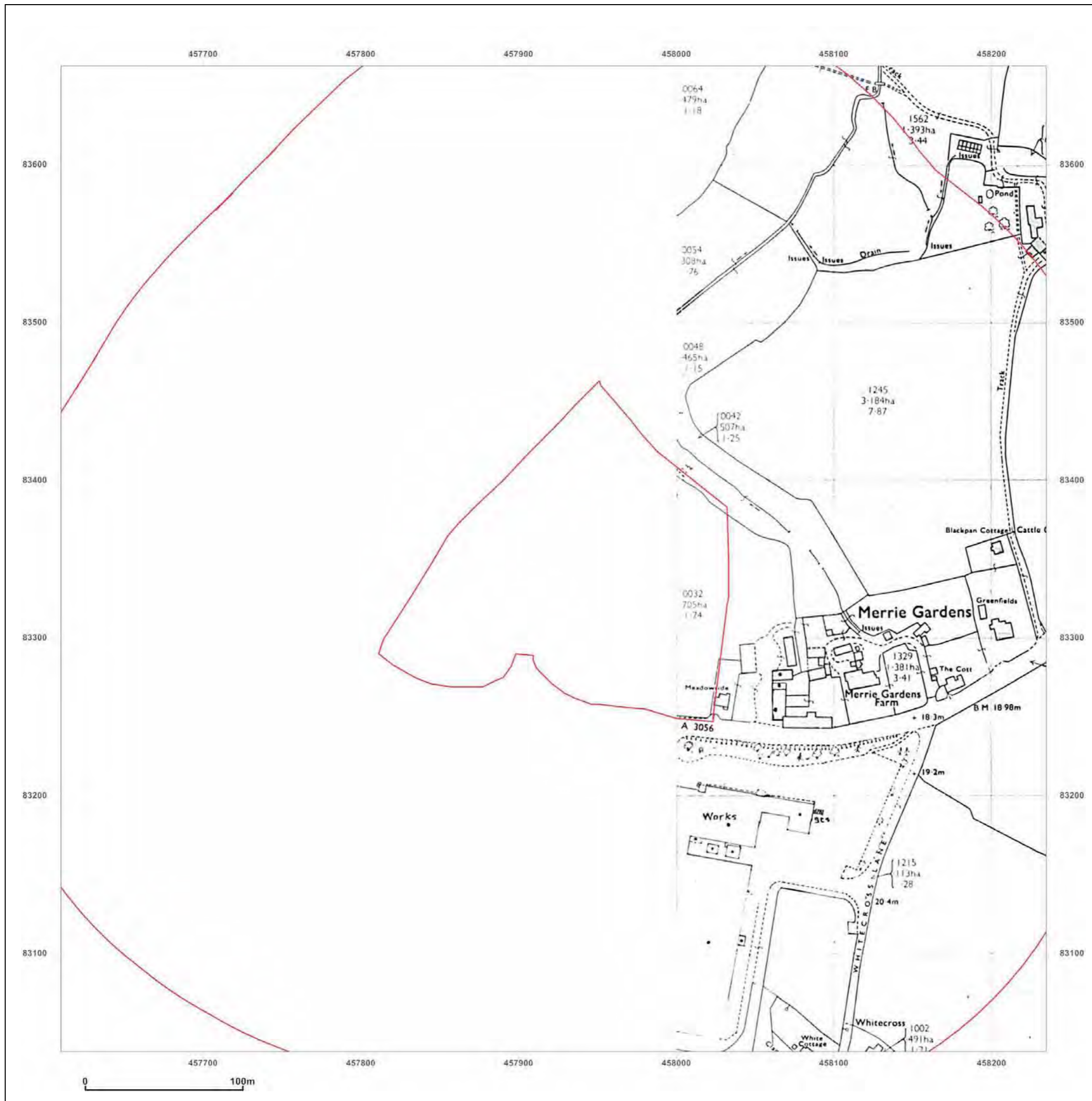

Site Details:

WM MORRISON
 SUPERMARKETS
 PLC, SERVICE
 STATION, NEWPORT
 ROAD, LAKE, SANDOWN, PO36
 9PA

Client Ref: 4960
Report Ref: CMAPS-AAA-86130-4960-020811HIS
Grid Ref: 457922, 83350

Map Name: County Series

Map date: 1908

Scale: 1:2,500

Printed at: 1:2,500

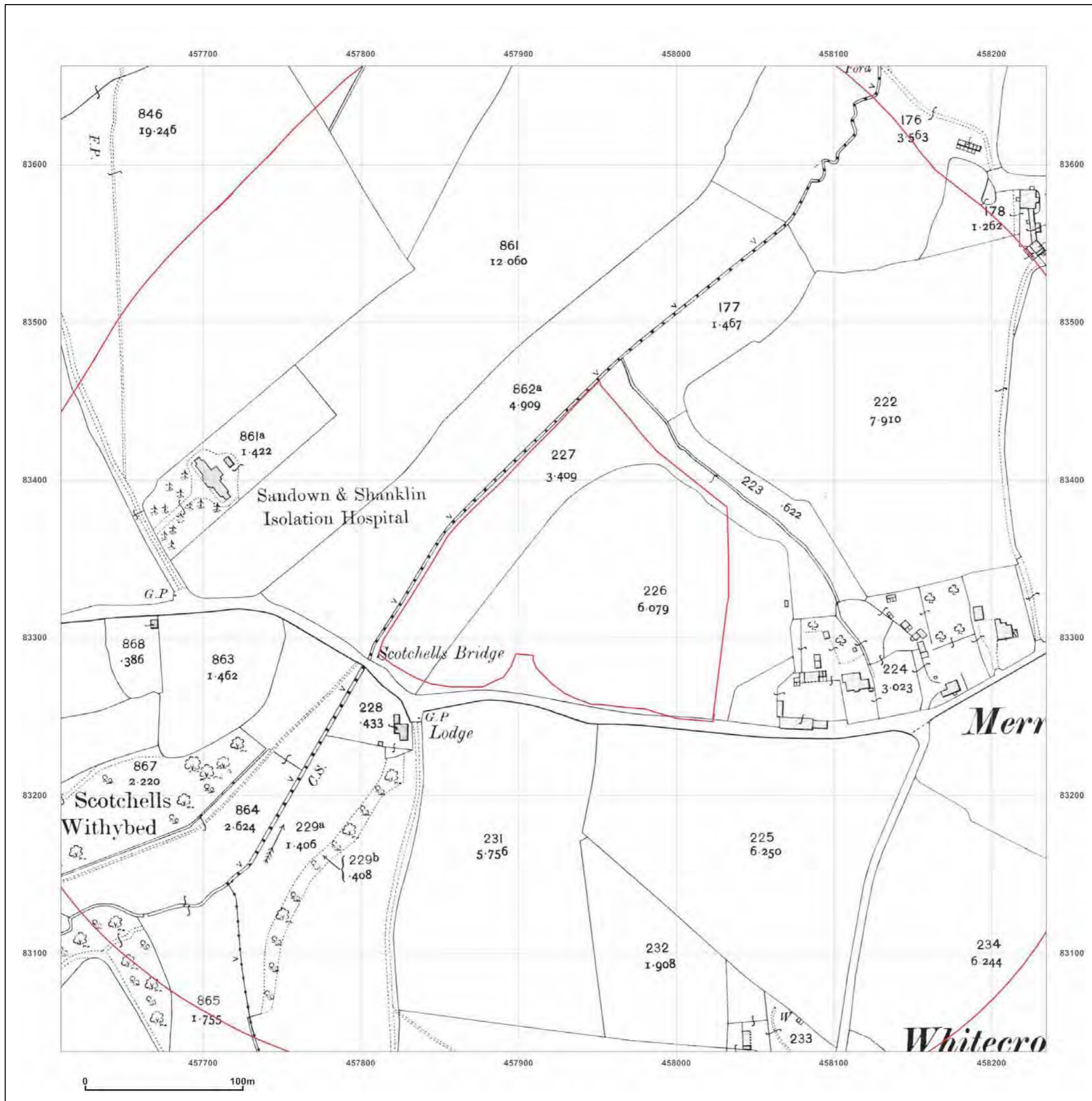

Surveyed 1908
 Revised 1908
 Edition NA
 Copyright NA
 Levelled NA



Produced by
 GroundSure Environmental Insight
www.groundsure.com



Supplied by:
www.centremapslive.com
Groundsure@centremaps.com

Crown copyright all rights reserved. Licence No: 100035207

Production date: 02 August 2011

To view map legend click here [Legend](#)

Site Details:

WM MORRISON
 SUPERMARKETS
 PLC, SERVICE
 STATION, NEWPORT
 ROAD, LAKE, SANDOWN, PO36
 9PA

Client Ref: 4960
Report Ref: CMAPS-AAA-86130-4960-020811HIS
Grid Ref: 457922, 83350

Map Name: County Series

Map date: 1898

Scale: 1:2,500

Printed at: 1:2,500

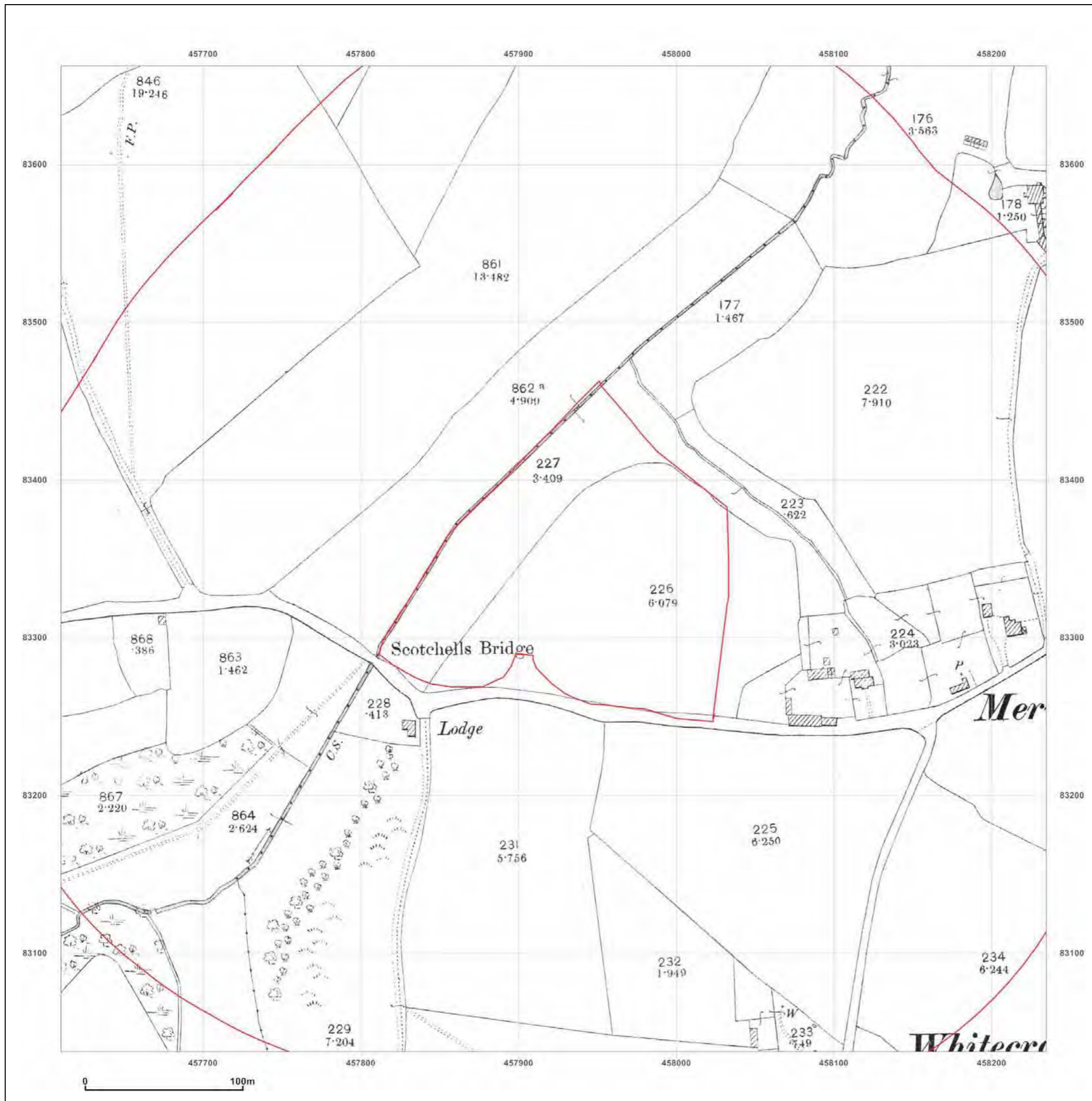

Surveyed 1898
 Revised 1898
 Edition NA
 Copyright NA
 Levelled NA



Produced by
 GroundSure Environmental Insight
www.groundsure.com



Supplied by:
www.centremapslive.com
Groundsure@centremaps.com

Crown copyright all rights reserved. Licence No: 100035207

Production date: 02 August 2011

To view map legend click here [Legend](#)



Site Details:

WM MORRISON
SUPERMARKETS
PLC, SERVICE
STATION, NEWPORT
ROAD, LAKE, SANDOWN, PO36
9PA

Client Ref: 4960
Report Ref: CMAPS-AAA-86130-4960-020811HIS
Grid Ref: 457922, 83350

Map Name: County Series

Map date: 1862

Scale: 1:2,500

Printed at: 1:2,500

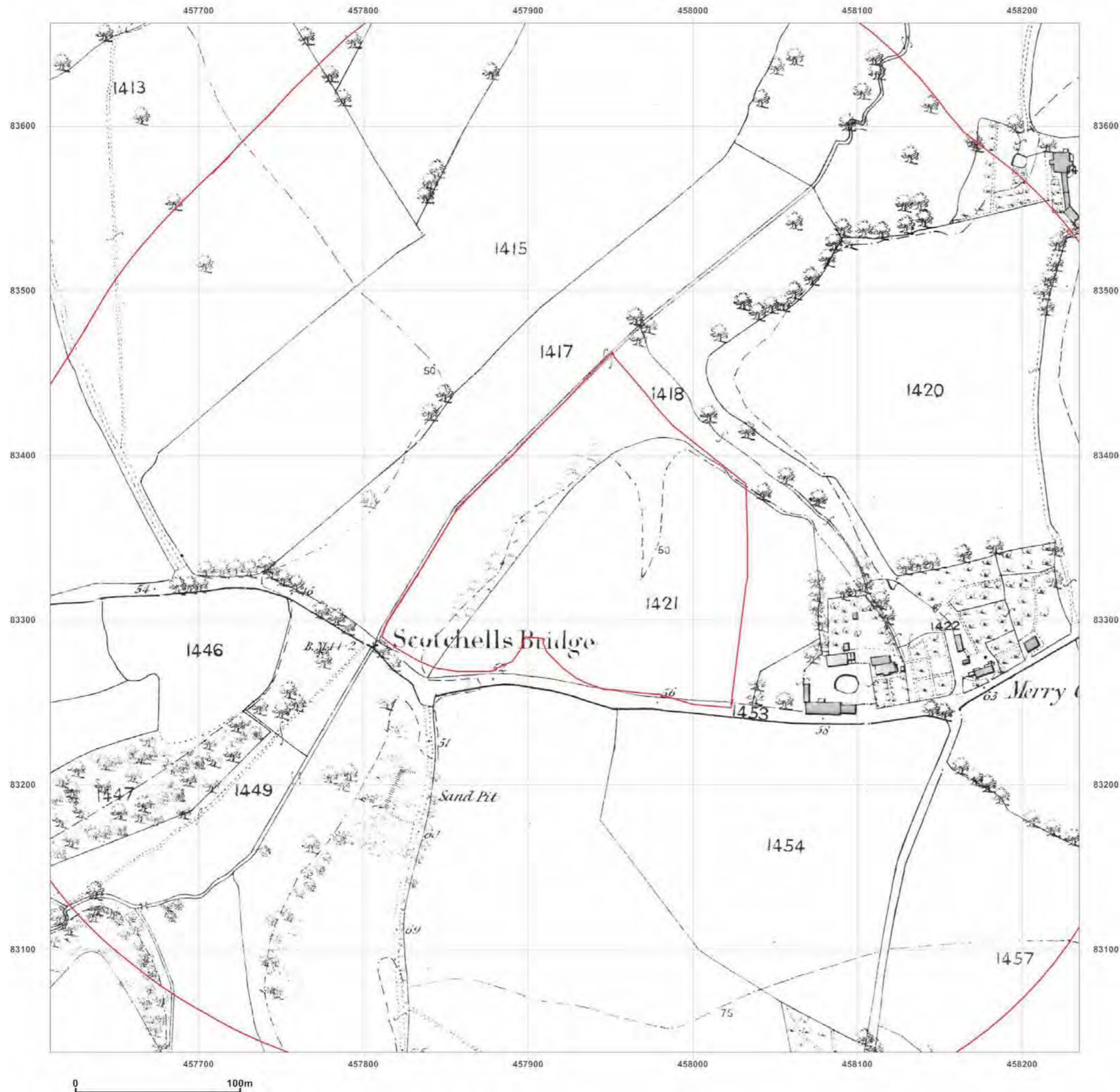

Surveyed 1862
Revised 1862
Edition NA
Copyright NA
Levelled NA



Produced by
GroundSure Environmental Insight
www.groundsure.com



Supplied by:
www.centremapslive.com
Groundsure@centremaps.com

Crown copyright all rights reserved. Licence No: 100035207

Production date: 02 August 2011

To view map legend click here [Legend](#)



Site Details:

WM MORRISON
SUPERMARKETS
PLC, SERVICE
STATION, NEWPORT
ROAD, LAKE, SANDOWN, PO36
9PA

Client Ref: 4960
Report Ref: CMAPS-AAA-86130-4960-020811HIS
Grid Ref: 457922, 83350

Map Name: National Grid

Map date: 2011

Scale: 1:10,000

Printed at: 1:10,000



Produced by
GroundSure Environmental Insight
www.groundsure.com



Supplied by:
www.centremapslive.com
Groundsure@centremaps.com

Crown copyright all rights reserved. Licence No: 100035207

Production date: 02 August 2011

To view map legend click here [Legend](#)



Site Details:

WM MORRISON
SUPERMARKETS
PLC, SERVICE
STATION, NEWPORT
ROAD, LAKE, SANDOWN, PO36
9PA

Client Ref: 4960
Report Ref: CMAPS-AAA-86130-4960-020811HIS
Grid Ref: 457922, 83350

Map Name: 1:10,000 Raster

Map date: 2002

Scale: 1:10,000

Printed at: 1:10,000

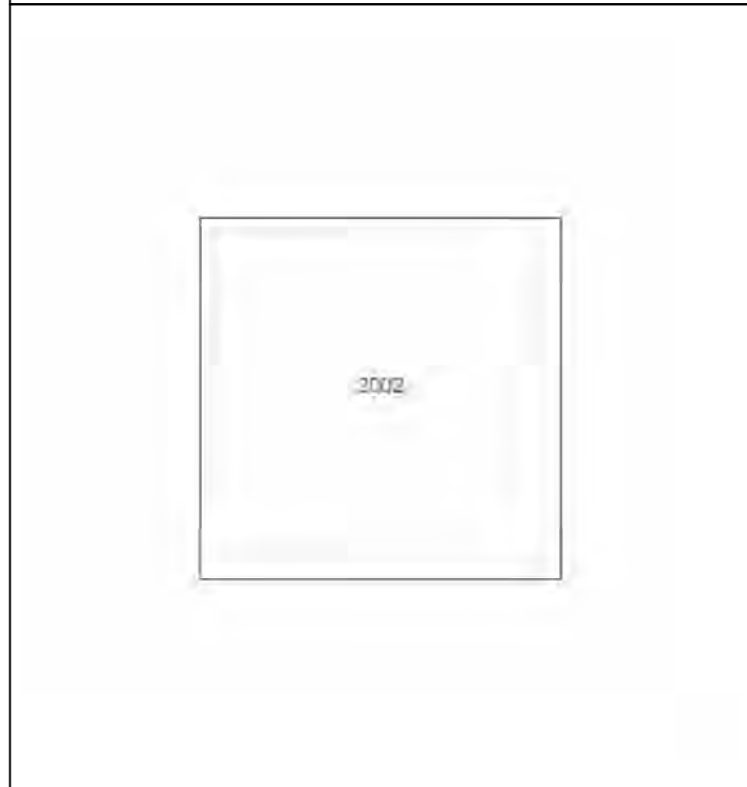

Produced by
GroundSure Environmental Insight
www.groundsure.com



Supplied by:
www.centremapslive.com
Groundsure@centremaps.com

Crown copyright all rights reserved. Licence No: 100035207

Production date: 02 August 2011

To view map legend click here [Legend](#)

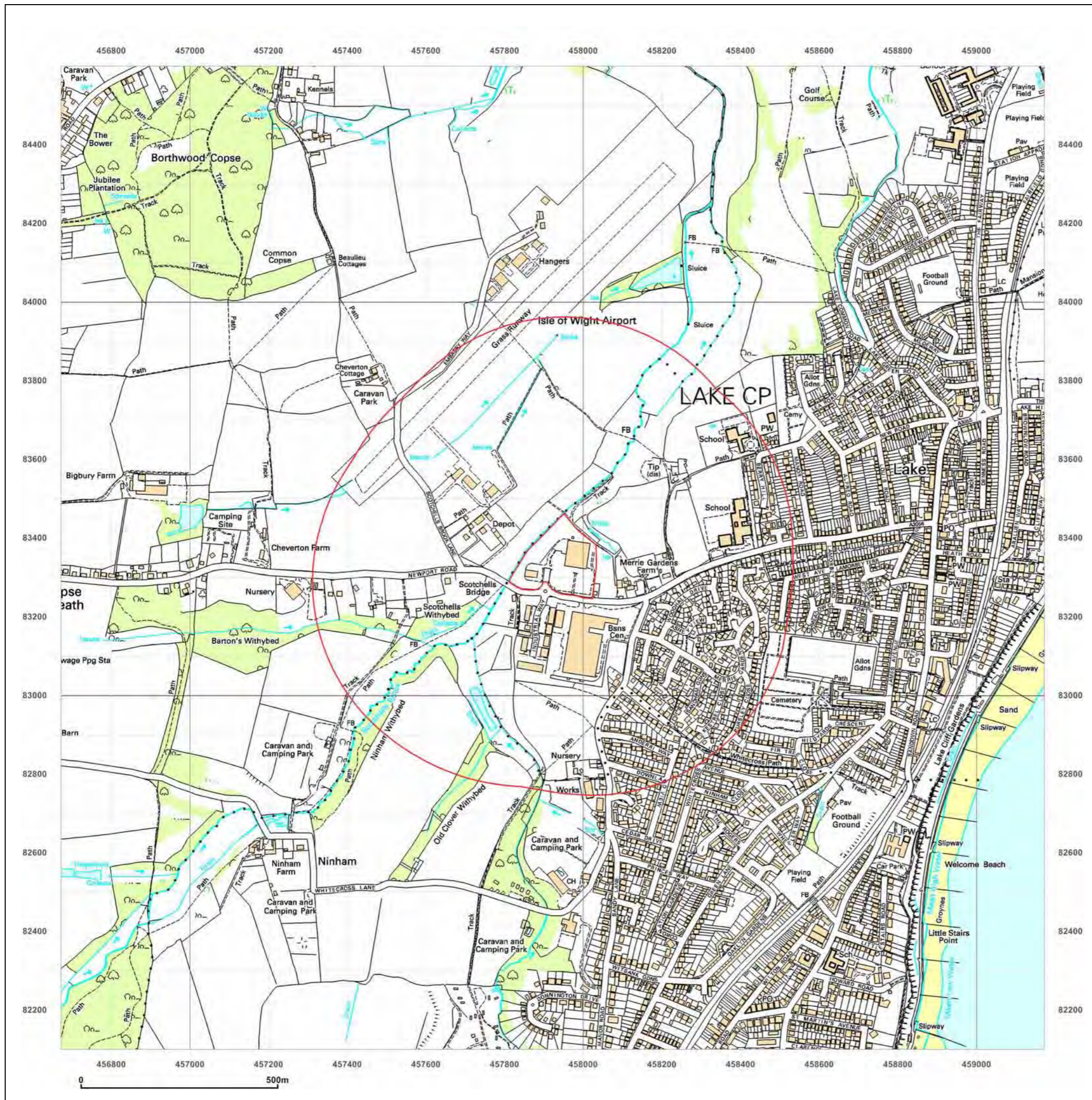



Site Details:

WM MORRISON
SUPERMARKETS
PLC, SERVICE
STATION, NEWPORT
ROAD, LAKE, SANDOWN, PO36
9PA

Client Ref: 4960
Report Ref: CMAPS-AAA-86130-4960-020811HIS
Grid Ref: 457922, 83350

Map Name: National Grid

Map date: 1980

Scale: 1:10,000

Printed at: 1:10,000



Surveyed 1979
Revised 1980
Edition NA
Copyright NA
Levelled NA



Produced by
GroundSure Environmental Insight
www.groundsure.com



Supplied by:
www.centremapslive.com
Groundsure@centremaps.com

Crown copyright all rights reserved. Licence No: 100035207

Production date: 02 August 2011

To view map legend click here [Legend](#)



Site Details:

WM MORRISON
SUPERMARKETS
PLC, SERVICE
STATION, NEWPORT
ROAD, LAKE, SANDOWN, PO36
9PA

Client Ref: 4960
Report Ref: CMAPS-AAA-86130-4960-020811HIS
Grid Ref: 457922, 83350

Map Name: Provisional

Map date: 1957

Scale: 1:10,560

Printed at: 1:10,560



Surveyed 1957
Revised 1957
Edition NA
Copyright NA
Levelled NA



Produced by
GroundSure Environmental Insight
www.groundsure.com



Supplied by:
www.centremapslive.com
Groundsure@centremaps.com

Crown copyright all rights reserved. Licence No: 100035207

Production date: 02 August 2011

To view map legend click here [Legend](#)



Site Details:

WM MORRISON
SUPERMARKETS
PLC, SERVICE
STATION, NEWPORT
ROAD, LAKE, SANDOWN, PO36
9PA

Client Ref: 4960
Report Ref: CMAPS-AAA-86130-4960-020811HIS
Grid Ref: 457922, 83350

Map Name: County Series

Map date: 1938-1942

Scale: 1:10,560

Printed at: 1:10,560



Surveyed 1862
Revised 1938
Edition NA
Copyright NA
Levelled NA

Surveyed 1862
Revised 1938
Edition NA
Copyright NA
Levelled NA

Surveyed 1862
Revised 1942
Edition NA
Copyright NA
Levelled NA



Produced by
GroundSure Environmental Insight
www.groundsure.com



Supplied by:
www.centremapslive.com
Groundsure@centremaps.com

Crown copyright all rights reserved. Licence No: 100035207

Production date: 02 August 2011

To view map legend click here [Legend](#)



Site Details:

WM MORRISON
SUPERMARKETS
PLC, SERVICE
STATION, NEWPORT
ROAD, LAKE, SANDOWN, PO36
9PA

Client Ref: 4960
Report Ref: CMAPS-AAA-86130-4960-020811HIS
Grid Ref: 457922, 83350

Map Name: County Series

Map date: 1907-1909

Scale: 1:10,560

Printed at: 1:10,560



Surveyed 1862
Revised 1909
Edition NA
Copyright NA
Levelled NA

Surveyed 1862
Revised 1907
Edition NA
Copyright NA
Levelled NA

Surveyed 1862
Revised 1907
Edition NA
Copyright NA
Levelled NA

Surveyed 1862
Revised 1907
Edition NA
Copyright NA
Levelled NA



Produced by
GroundSure Environmental Insight
www.groundsure.com



Supplied by:
www.centremapslive.com
Groundsure@centremaps.com

Crown copyright all rights reserved. Licence No: 100035207

Production date: 02 August 2011

To view map legend click here [Legend](#)

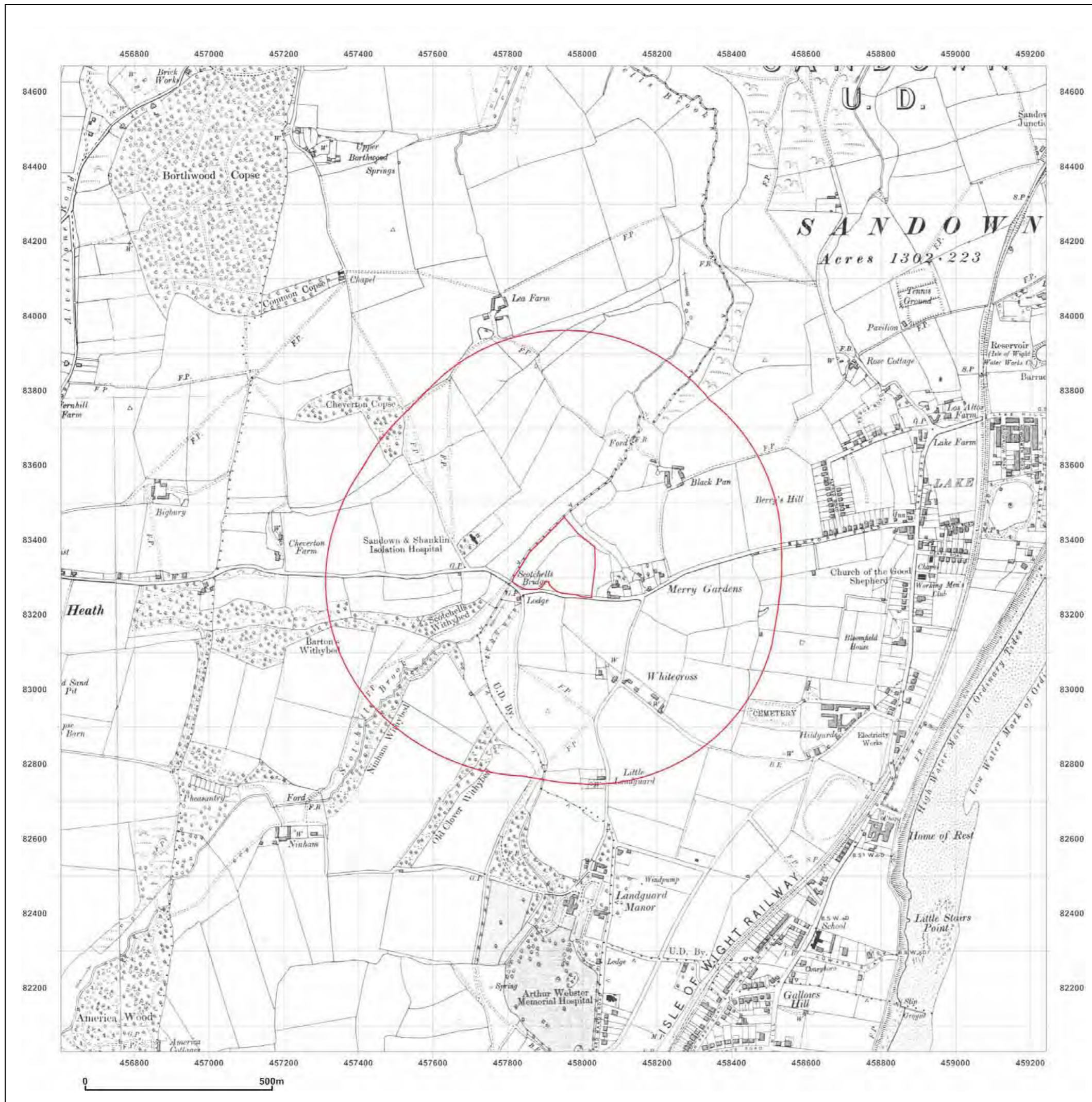

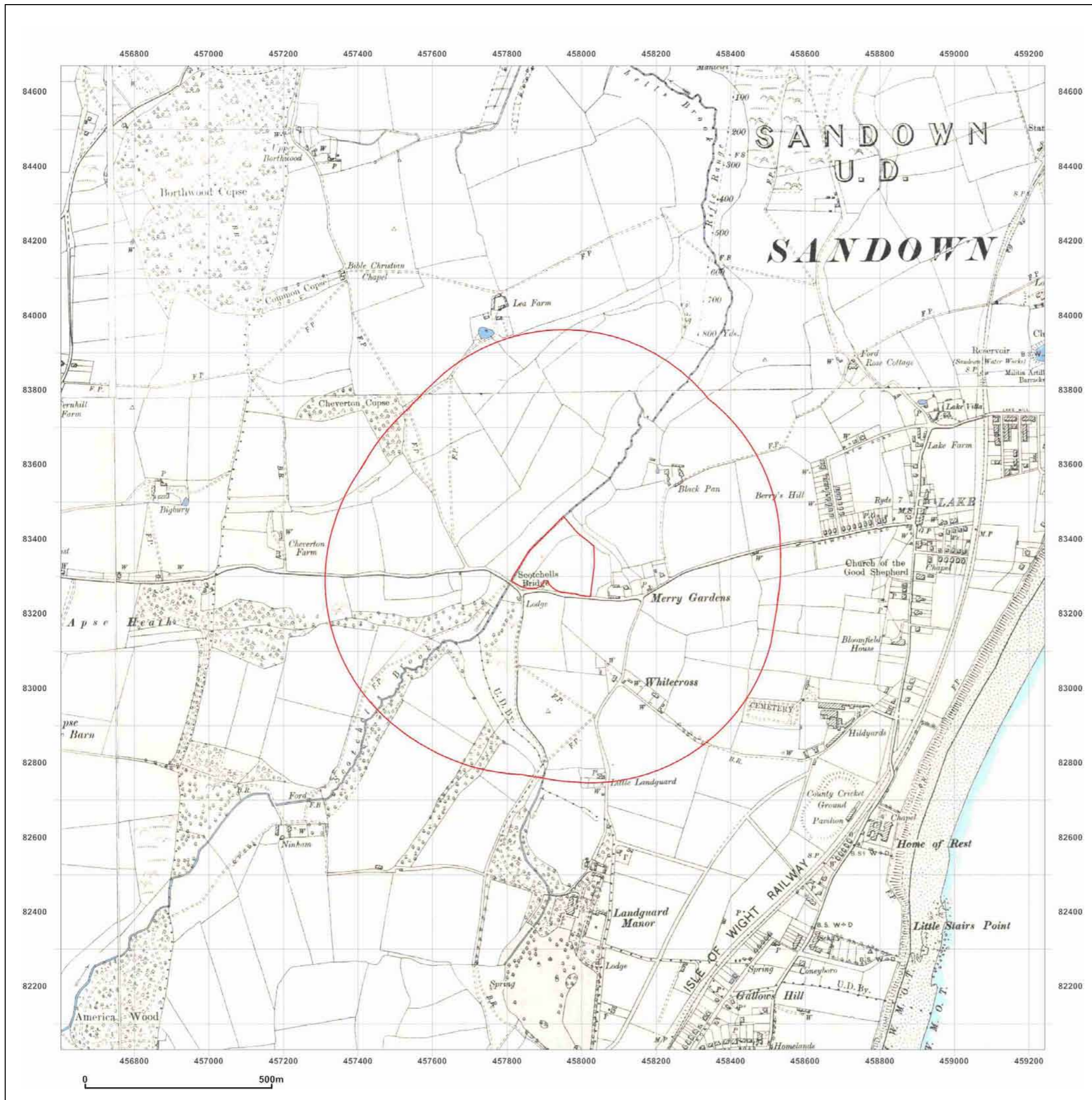

Site Details:

WM MORRISON
SUPERMARKETS
PLC, SERVICE
STATION, NEWPORT
ROAD, LAKE, SANDOWN, PO36
9PA

Client Ref: 4960
Report Ref: CMAPS-AAA-86130-4960-020811HIS
Grid Ref: 457922, 83350

Map Name: County Series

Map date: 1896

Scale: 1:10,560

Printed at: 1:10,560



Surveyed 1863
Revised 1896
Edition NA
Copyright NA
Levelled NA

Surveyed 1863
Revised 1896
Edition NA
Copyright NA
Levelled NA

Surveyed 1863
Revised 1896
Edition NA
Copyright NA
Levelled NA

Surveyed 1863
Revised 1896
Edition NA
Copyright NA
Levelled NA



Produced by
GroundSure Environmental Insight
www.groundsure.com



Supplied by:
www.centremapslive.com
Groundsure@centremaps.com

Crown copyright all rights reserved. Licence No: 100035207

Production date: 02 August 2011

To view map legend click here [Legend](#)



Site Details:

WM MORRISON
SUPERMARKETS
PLC, SERVICE
STATION, NEWPORT
ROAD, LAKE, SANDOWN, PO36
9PA

Client Ref: 4960
Report Ref: CMAPS-AAA-86130-4960-020811HIS
Grid Ref: 457922, 83350

Map Name: County Series

Map date: 1861-1863

Scale: 1:10,560

Printed at: 1:10,560



Surveyed 1863 Revised 1863 Edition NA Copyright NA Levelled NA	Surveyed 1861 Revised 1861 Edition NA Copyright NA Levelled NA
Surveyed 1863 Revised 1863 Edition NA Copyright NA Levelled NA	Surveyed 1863 Revised 1863 Edition NA Copyright NA Levelled NA

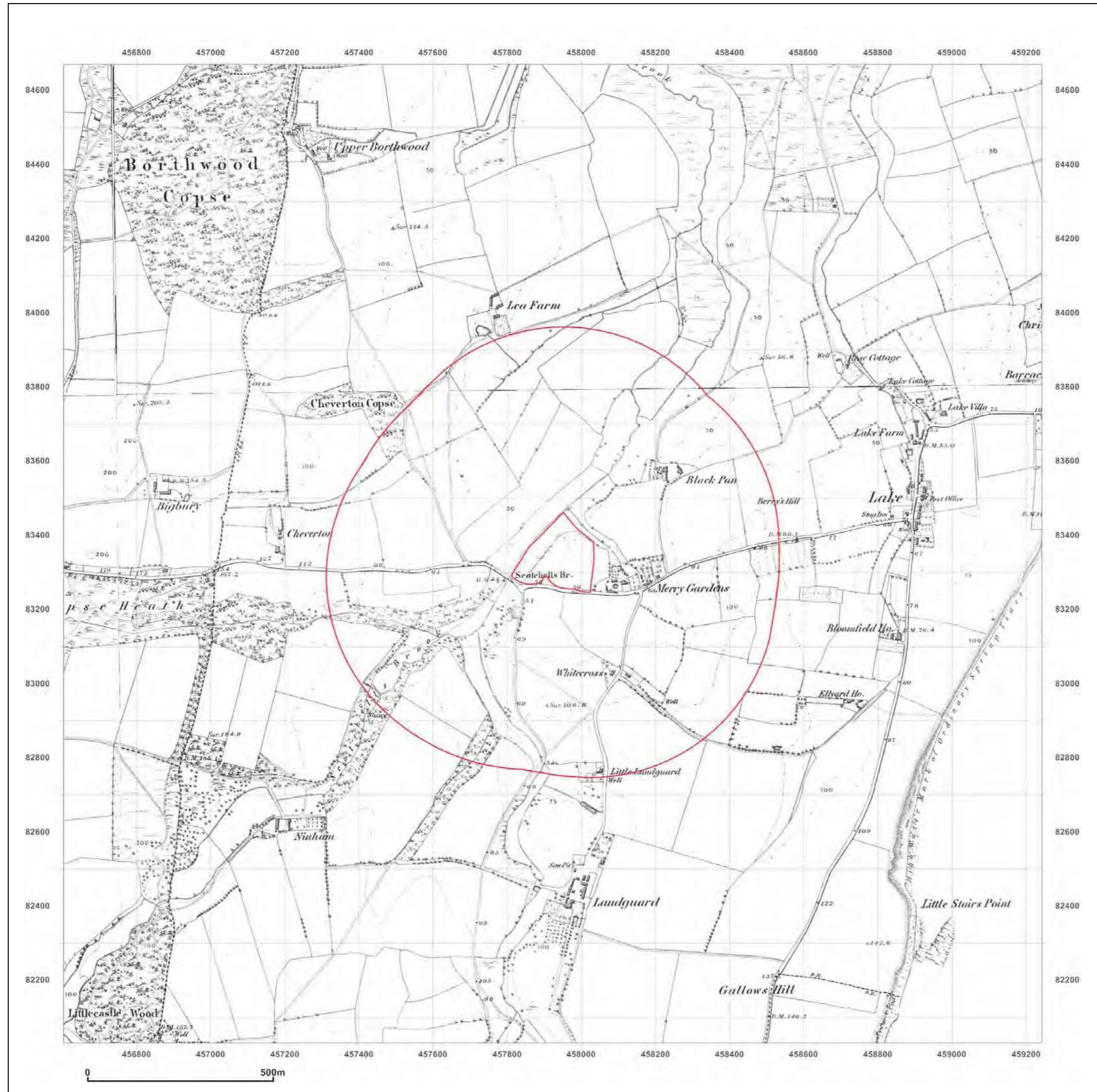

Produced by GroundSure Environmental Insight
www.groundsure.com

Licensed Partner
Supplied by:
www.centremapslive.com
Groundsure@centremaps.com

Crown copyright all rights reserved. Licence No: 100035207

Production date: 02 August 2011

To view map legend click here [Legend](#)



global environmental solutions

AYLESBURY

7 Wornal Park, Menmarsh Road,
Worminghall, Aylesbury,
Buckinghamshire HP18 9PH
T: +44 (0)1844 337380

BELFAST

24 Ballynahinch Street, Hillsborough,
Co. Down, BT26 6AW Northern Ireland
T: +44 (0)28 9268 9036

BRADFORD-ON-AVON

Treenwood House, Rowden Lane,
Bradford-on-Avon, Wiltshire BA15 2AU
T: +44 (0)1225 309400

BRISTOL

Langford Lodge, 109 Pembroke Road,
Clifton, Bristol BS8 3EU
T: +44 (0)117 9064280

CAMBRIDGE

8 Stow Court, Stow-cum-Quy,
Cambridge CB25 9AS
T: + 44 (0)1223 813805

CARDIFF

Fulmar House, Beignon Close, Ocean
Way, Cardiff CF24 5HF
T: +44 (0)29 20491010

CHELMSFORD

Unit 77, Waterhouse Business Centre,
2 Cromar Way, Chelmsford, Essex
CM1 2QE
T: +44 (0)1245 392170

DUBLIN

7 Dundrum Business Park, Windy
Arbour, Dundrum, Dublin 14 Ireland
T: + 353 (0)1 2964667

EDINBURGH

No. 4 The Roundal, Roddinglaw
Business Park, Gogar, Edinburgh
EH12 9DB
T: +44 (0)131 3356830

EXETER

69 Polsloe Road, Exeter EX1 2NF
T: + 44 (0)1392 490152

FARNBOROUGH

The Pavilion, 2 Sherborne Road, South
Farnborough, Hampshire GU14 6JT
T: +44 (0)1252 515682

GLASGOW

4 Woodside Place, Charing Cross,
Glasgow G3 7QF
T: +44 (0)141 3535037

HUDDERSFIELD

Westleigh House, Wakefield Road,
Denby Dale, Huddersfield HD8 8QJ
T: +44 (0)1484 860521

LEEDS

Suite 1, Jason House, Kerry Hill,
Horsforth, Leeds LS18 4JR
T: +44 (0)113 2580650

MAIDSTONE

19 Hollingworth Court, Turkey Mill,
Maidstone, Kent ME14 5PP
T: +44 (0)1622 609242

NEWCASTLE UPON TYNE

Sailors Bethel, Horatio Street,
Newcastle-upon-Tyne NE1 2PE
T: +44 (0)191 2611966

NOTTINGHAM

Aspect House, Aspect Business Park,
Bennerley Road, Nottingham NG6 8WR
T: +44 (0)115 9647280

ST. ALBAN'S

White House Farm Barns, Gaddesden
Row, Hertfordshire HP2 6HG
T: +44 (0)1582 840471

SHEFFIELD

STEP Business Centre, Wortley Road,
Deepcar, Sheffield S36 2UH
T: +44 (0)114 2903628

SHREWSBURY

Mytton Mill, Forton Heath, Montford
Bridge, Shrewsbury SY4 1HA
T: +44 (0)1743 850170

STAFFORD

8 Parker Court, Staffordshire Technology
Park, Beaconside, Stafford ST18 0WP
T: +44 (0)1785 253331

WARRINGTON

Suite 9 Beech House, Padgate Business
Park, Green Lane, Warrington WA1 4JN
T: +44 (0)1925 827218

WORCESTER

Suite 5, Brindley Court, Gresley Road,
Shire Business Park, Worcester
WR4 9FD
T: +44 (0)1905 751310



Energy



Waste
Management



Planning &
Development



Industry



Mining
& Minerals



Infrastructure